

INSTRUCTIONS FOR USE

TO GET CORRECT TEST RESULT...

...DO NOT eat, drink, chew gum or smoke for at least 10 minutes prior to collection.



The goal is to collect saliva into the sample tube.

- 1 Open the collection set and mount the funnel onto the sample tube.



Important: cough out several times before collection (wearing respirator or facemask).

- 3 Build up sufficient amount of saliva in your mouth and roll it round your mouth several times.

- 4 Let the saliva drip freely from your mouth into the collection funnel until there is at least 1 cm of liquid (not foam) in the tube.

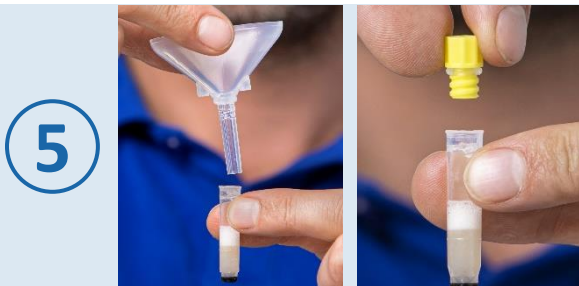

Remove the funnel and dispose of it. **Make sure the tube is tightly capped.**

- 6 Wipe the collection tube using a disinfectant wipe and hand it over.



Warning: Do not lick or chew any parts of the collection set.

Instructions for sampling sites

DB-1221 Saliva Collection Set 1.1IM

- Cat. #: DB-1221-1.1IM-1set (1 piece)
- Cat. #: DB-1221-1.1IM-100sets (100 pieces)
- Cat. #: DB-1221-1.1IM-200sets (200 pieces)
- Cat. #: DB-1221-1.1IM-500sets (500 pieces)

DB-1230 Saliva Collection Set 1.4IF

- Cat. #: DB-1230-1.4IF-1set (1 pieces)
- Cat. #: DB-1230-1.4IF-200sets (100 pieces)
- Cat. #: DB-1230-1.4IF-100sets (200 pieces)
- Cat. #: DB-1230-1.4IF-500sets (500 pieces)

DB-1225 Saliva Collection Set 1.4IM

- Cat. #: DB-1225-1.4IM-1set (1 pieces)
- Cat. #: DB-1225-1.4IM-100sets (100 pieces)
- Cat. #: DB-1225-1.4IM-200sets (200 pieces)
- Cat. #: DB-1225-1.4IM-500sets (500 pieces)



This kit is used for saliva collection for testing of SARS-CoV-2 virus presence:

- ❖ The tested person must be instructed on the collection procedure in accordance with the front page of this document.
- ❖ The tested person must cough out several times before saliva collection to ensure the test sensitivity.
- ❖ Make sure that the level of saliva is sufficiently high in the collection tube:
 - ❖ The level of saliva must reach at least 1 cm above the black bottom of the tube,
 - ❖ In case of insufficient amount of saliva it is necessary to repeat the collection procedure.
- ❖ Check that the tube is properly capped before transporting the sample.

Sample storage and transport:

- ❖ This sampling kit is recommended to be used with DB-1219 DBdirect™ COVID-19 Multiplex RT-PCR Kit
- ❖ The collection tube with the saliva can be stored at the temperature of 4°C to 25°C for up to 72 hours without any loss of sensitivity. The recommended storage temperature is 25°C.
- ❖ If different detection kit is used with this collection set, it is mandatory for the laboratory to test and validate the storage conditions.
- ❖ For easier handling of samples we recommend the use of the vial racks for transport:
 - ❖ DB-1227 – Sample Rack 1.1IM (compatible with DB-1221)
 - ❖ DB-1228 – Sample Rack 1.4IM (compatible with DB-1225 and DB-1230)

Sample identification (scanning):

- ❖ For easier identification of samples each tube is labeled with a 2D matrix code at the bottom. This matrix code is unique and can be used to pair the patient information with the code for easier tracking.

We highly recommend to provide disinfectant wipes at the collection site for the tested persons to disinfect their hands and wipe the tubes with saliva before handing them over to the staff of the testing site.

Instruction leaflet and User manual for DB-1221 Saliva Collection Set 1.1IM;
DB-1225 Saliva Collection Set 1.4IM; DB-1230 Saliva Collection Set 1.4IF

Version DB-1221(1225,1230)-001-201211 EN | Revision 1.6 EN | last update: 15.4.2021



DIANA Biotechnologies s.r.o., Nad Safinou II 366, 25250 Vestec, Czech Republic
Email: support@dianabiotech.com, Web: www.dianabiotech.com